



# Mayne Tree Expert Company, Inc.

ESTABLISHED 1931

STATE CONTRACTOR'S LICENSE NO. 276793

CERTIFIED FORESTER • CERTIFIED ARBORISTS • PEST CONTROL • ADVISORS AND OPERATORS

RICHARD L. HUNTINGTON  
PRESIDENT

JEROMEY INGALLS  
CONSULTANT/ESTIMATOR

535 BRAGATO ROAD, STE. A  
SAN CARLOS, CA 94070-6311

TELEPHONE: (650) 593-4400  
FACSIMILE: (650) 593-4443  
EMAIL: info@maynetree.com

April 13, 2020  
(Updated August 12, 2020)

Ms. Natalie Hyland  
Hyland Design Group  
585 Quarry Rd.  
San Carlos, CA 94070

Dear Ms. Hyland,

RE: GARY ERNST, DOLTON AVENUE, LOT #1, SAN CARLOS (UNINCORPORATED)

I have made a visit to this site and found 5 trees. Tree #3 is on the adjacent property and to be protected. Trees #1 and #2 are in the proposed driveway footprint, tree #4 is in the proposed home footprint, and tree #5 is desired to be removed.

Each tree was identified, measured, and given a condition rating. The rating is a comparison of the tree to a perfect tree. The following table will help explain these condition ratings:

0	-	29	Very Poor
30	-	49	Poor
50	-	69	Fair
70	-	89	Good
90	-	100	Excellent

The Comments column will help explain the condition rating, tree protection, and other individual tree characteristics. One may also find recommendations for pruning and general tree healthcare.

Due to the potential amount of excavation, tree protection on this steep bank below the road can be difficult. The proposed footprint of the driveway goes down through trees #1 and #2 and no tree protection will be needed.

Tree protection would require chain link fencing installed along the road and around the dripline of the tree. If kept, tree #5 can be fenced off along the flat area above the tree. (See site plan.) These areas are off limits to all construction equipment and materials.

Have the protective fencing inspected for adequacy or send photos. The next inspection will be to check excavations. An inspection report will be submitted.

I think this report is accurate and based on sound arboricultural principles and practices.

Sincerely,



Richard L. Huntington  
Certified Arborist WE #0119A  
Certified Forester #1925

RLH:pmd



## Tree Survey

Tree #	Species	Diameter (inches)	Condition (percent)	Height (feet)	Comments
1	Redwood	30, 20, 10 (est.)	50	65	3 stems at ground level; fence at drip line. Permit needed to remove. In driveway footprint.
2	Coast Live Oak	5	12	50	Volunteer; leans at 45 degrees; in driveway footprint.
3	Coast Live Oak	28 (est.)	50	55	On 115 Dolton Avenue; leans; no construction impact. Fence off at drip line.
4	Stone Pine	7.5, 5.4, 4.7	20	50	In proposed home footprint.
5	Blue Gum	65 (est.)	60	100 (est.)	On bank; no impact from construction; prudent to remove. No permit needed to remove.

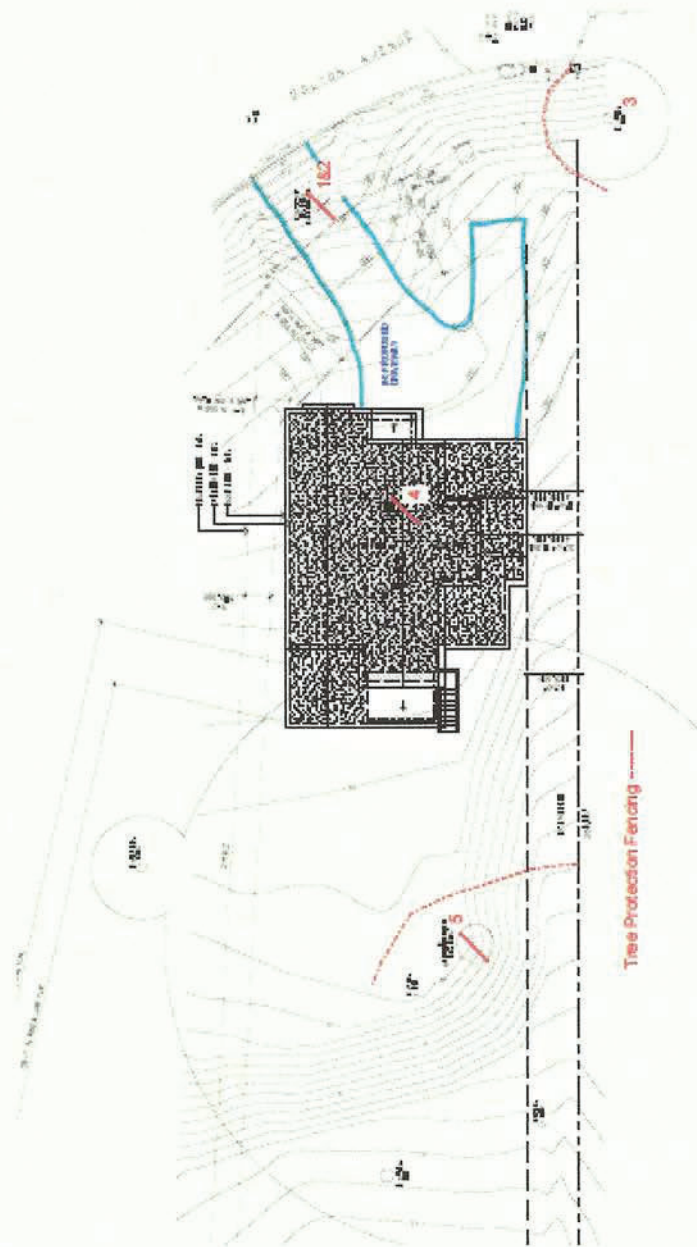

See tree numbers & fencing site plan (pdf) attached to email with this letter.